

**2 Bed
Flat
located in Southmead**



236 Southmead Road
Southmead
Bristol
BS10 5EN



£1,450 Per month

Well-Presented Two Bedroom flat on Southmead Road

Offered in excellent decorative order throughout, this two bedroom property is ideally positioned on Southmead Road, within easy reach of Southmead Hospital, Filton Aerospace, local shops, amenities and regular bus routes into Bristol city centre, perfect for couples or professional sharers.

The heart of the home is a bright, open plan lounge with a fully fitted kitchen, complete with gas hob, electric oven and all white goods included, so you can move straight in with minimal fuss.

The property offers two bedrooms - a generous main double and a second smaller double - along with a bathroom fitted with both a bath and shower.

Further benefits include gas central heating, double glazing throughout, and an allocated parking space for one car.

Key Features:

- Two double bedrooms
- Open plan lounge with fully fitted kitchen
- All white goods included
- Bathroom with bath and overhead shower
- Gas central heating and double glazing
- Allocated parking for one car



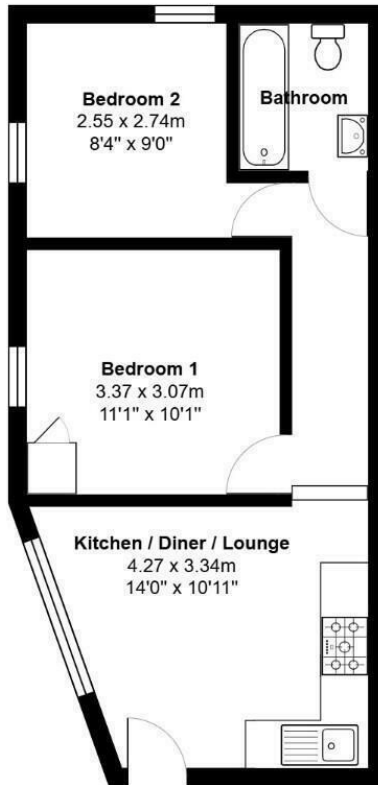

Energy Efficiency Rating		
	Current	Potential
<i>Very energy efficient - lower running costs</i>		
(92 plus) A		
(81-91) B		
(69-80) C		
(55-68) D		
(39-54) E		
(21-38) F		
(1-20) G		
<i>Not energy efficient - higher running costs</i>		
England & Wales	EU Directive 2002/91/EC	

DIRECTIONS

CONTACT

Shore House Westbury Hill
Westbury-on Trym, Bristol
BS9 3AA

E: elliott.sherwood@frontdoorlettings.co.uk

T: 0117 457 8577

frontdoorlettings.co.uk

